

G Floor, 10 Ironmonger Lane

City of London

Sq Ft: 565

Monthly Price: £7,000





Floor Plan

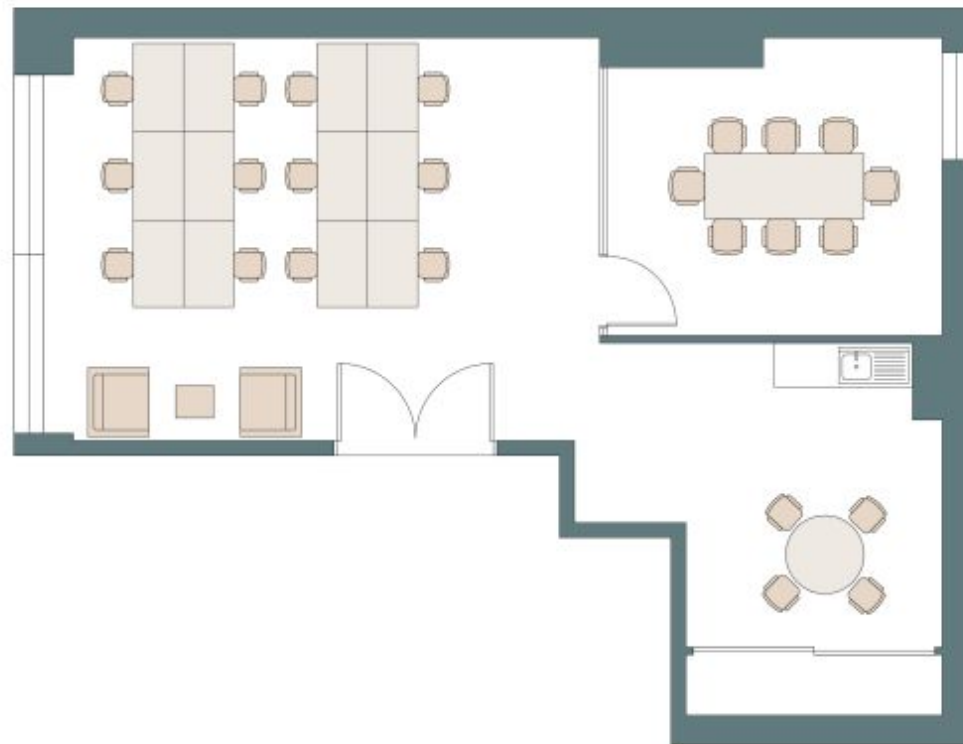

About This Workspace

10 Ironmonger Lane offers a modern and efficient workspace in the heart of the City of London, perfect for smaller businesses looking to establish a central presence. The contemporary interiors are designed with functionality and style in mind, creating a welcoming environment that's well-suited for productivity. Situated in a prime location, 10 Ironmonger Lane provides easy access to the area's renowned financial and professional services, along with a variety of shops, cafés, and transport links. This office is ideal for businesses seeking a smart, well-connected base in London's bustling business district.

Workspace Amenities



Air Conditioning



Excellent Natural Light



Meeting Rooms

Workspace Specification

Floor/Unit	Status	Size	Price	Term
G Floor	Available	565	£7,000	24 months

Connectivity

10 Ironmonger Lane offers a modern and efficient workspace in the heart of the City of London, perfect for smaller businesses looking to establish a central presence. The contemporary interiors are designed with functionality and style in mind, creat...



 Bank Station – 4 mins walk



 St Paul's – 7 mins walk



 Moorgate – 11 mins walk



Workspace Services

Included in your sub800 workspace



Remote Concierge Service

Our remote concierge team is on hand to support you. From sourcing catering for important meeting, to planning wellness workshops, and everything in between...



Food & Beverage Deliveries

Enjoy a tailored choice of food and beverages delivered to your office. Our selections are carefully curated by our team to offer your business delightful options.



Internet & Technology

Select from a variety of internet bandwidth options, along with access to other technology products to upgrade your space



Cleaning & Waste Services

Access to allocated cleaning slots, reporting and products to suit your team's needs. Our cleaning saves you time arranging cleaning or doing it yourself.



Furniture & Fit-Out

Browse on the sub800 shop for our extensive range of furniture items, meeting room installations, have a bespoke consultation with our team.



Health & Safety Onboarding

A comprehensive health and safety onboarding pack that details how you can ensure your workspace is safe, as well as a list of preferred suppliers and rates



Repairs & Support

sub800 provide your business with light repairs and the option to source specialist works with preferred suppliers and rates



Member's Club Access

Access to exclusive member's clubs for the C-Suite level of your team, giving them access to external meeting space, events and networking opportunities

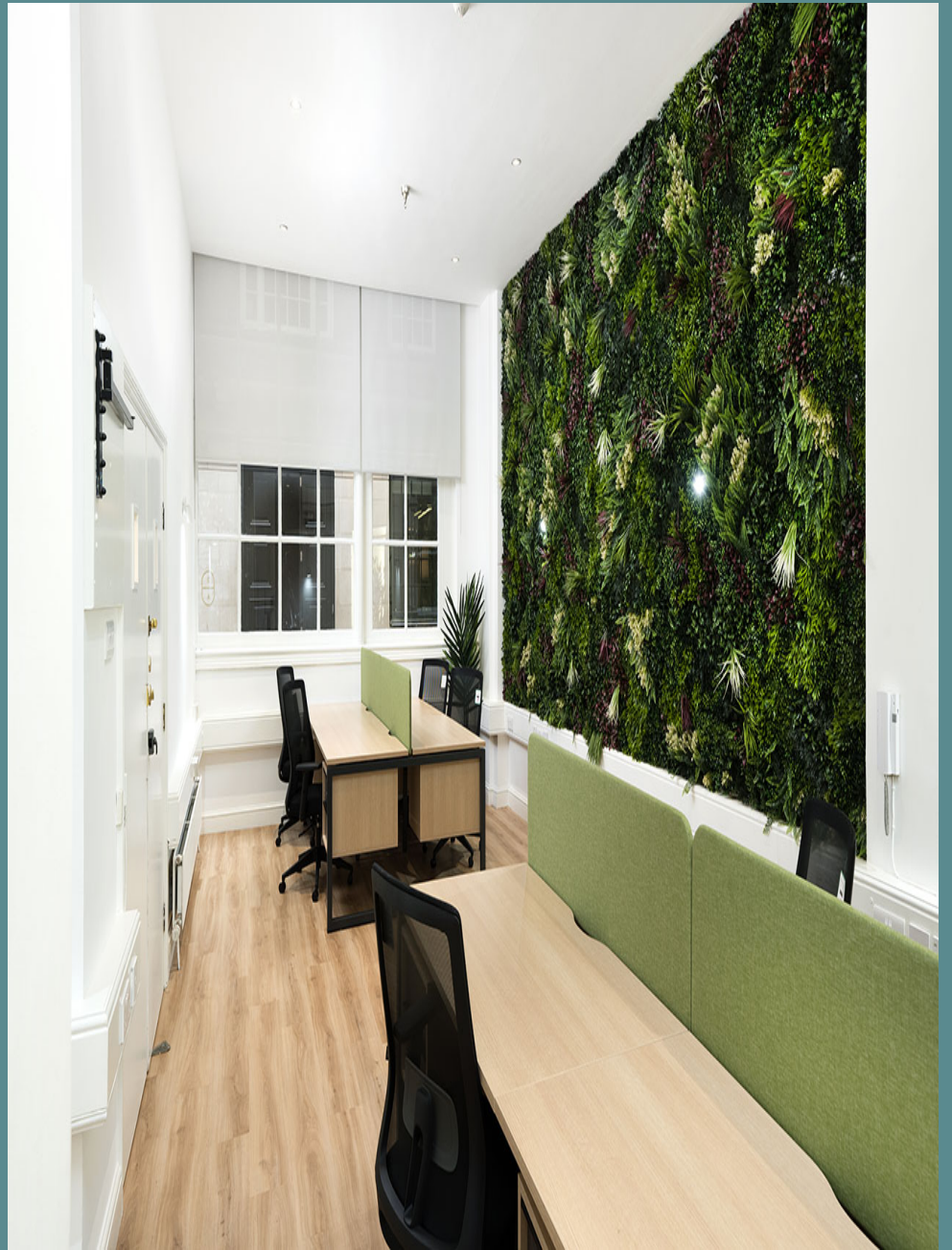



[Make An Enquiry](#)

[Book A Viewing](#)

enquiries@sub800.com | [0207 052 3025](tel:02070523025) | www.sub800.com